



Balance beams and stepping logs constructed from natural materials present challenges and develop coordination and confidence



Define spaces with interesting elements made from natural materials



Timber bridge marks the entry to the play sequence



Synthetic grass can be contoured into mounds, adding an extra element of fun



Balance beam circuits promote cooperation and co-ordination between children



Keep it simple with Rock Grinding!



Passive play areas are an important element to every playground

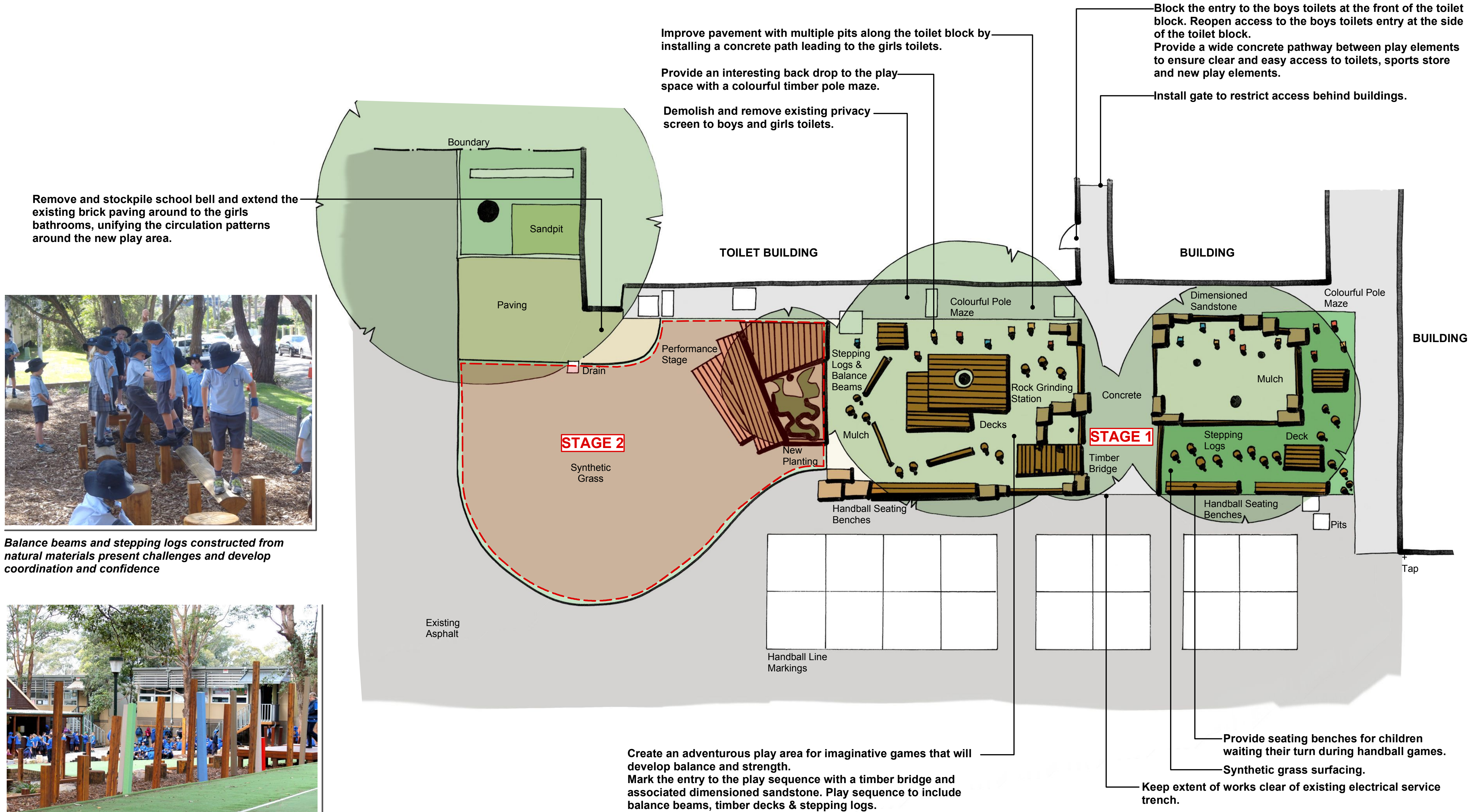

Sandstone is typical of the Sydney region, it is attractive and great for creating interesting edges.



I like to play!



Synthetic grass is hard wearing and can easily transform asphalt areas into attractive play spaces

